

MILWAUKIE BAY PARK FINAL DESIGN

April 24, 2019



WHAT WILL YOU HEAR TODAY?

- **WHAT HAVE WE HEARD TO DATE?**
- **2010 MASTER PLAN AND PROGRAM**
- **FINAL DESIGN**
- **OPEN HOUSE**

- **WHAT HAVE WE HEARD TO DATE?**
- **2010 MASTER PLAN AND PROGRAM**
- **FINAL DESIGN**
- **OPEN HOUSE**



AUGUST 2018 PARK DESIGN SURVEY RESULTS

AUGUST 2018 OUTREACH HIGHLIGHTS



775

Online Survey
Respondents



141

Comment Cards
Collected

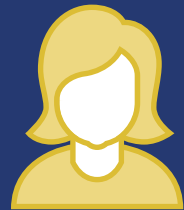

~350

Event Attendees
and Respondents



AUGUST 2018 PARK DESIGN SURVEY RESULTS

Survey Results images shown here include the top two selections from each survey question and are indicative of the type of proposed site elements, but not exact representations.

PUBLIC ART (Top Voted)



Integrated Park Elements



Interactive

RELAXING IN THE PARK (Top Voted)

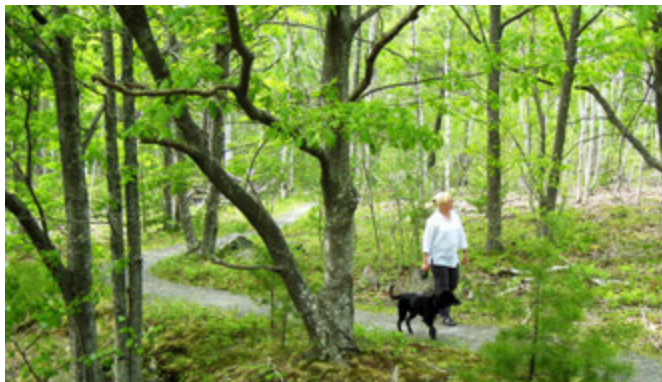

Enjoying Nature



Picnicking

NATURE (Top Voted)



Shade & Tree Canopy



Trees & Lawn

CHILDREN'S PLAY AREA (Top Voted)



Imagination/Exploration



Nature Play

WATER FEATURES (Top Voted)



Nature Spray



Natural Looking

GATHERING AREA (Top Voted)



Terraced Amphitheater



Performance Space



NOV/DEC 2018 PUBLIC ENGAGEMENT SUMMARY

RECURRING THEMES FROM COMMUNITY RESPONSES

- Alternatives 1 & 2 favored over 3
- Locate the play area & restroom close to one another
- Locate the play area & water feature away from the street
- Provide universal access and connections between activities
- Protect & frame views
- Provide shade
- Incorporate natural area
- Provide flexible spaces
- Amphitheater near stairs/beach with some seat walls
- Make inviting entry at Washington St. (south)
- Include multiple picnic areas

OUTREACH HIGHLIGHTS



376

Online Survey Respondents



48

Comment Cards Collected



~85

Event Attendees and Respondents



~40

Small Group Discussion Participants

FLOW | Alternative 1
 Natural flow and feel of the site
 Less urban/architectural (more inviting)
 Flexible amphitheater
 Location of the amphitheater
 Large seating/picnic area



FLUVIAL | Alternative 2
 Function of the site
 Direct connections
 Terraced amphitheater w/seatwalls
 Location of amphitheater
 Playground and water feature pushed further from 99E



VISTA | Alternative 3
 Nature
 Direct access from Monroe Street Plaza to the Willamette riverfront



FINAL DESIGN

- **WHAT HAVE WE HEARD TO DATE?**
- **2010 MASTER PLAN AND PROGRAM**
- **FINAL DESIGN**
- **OPEN HOUSE**

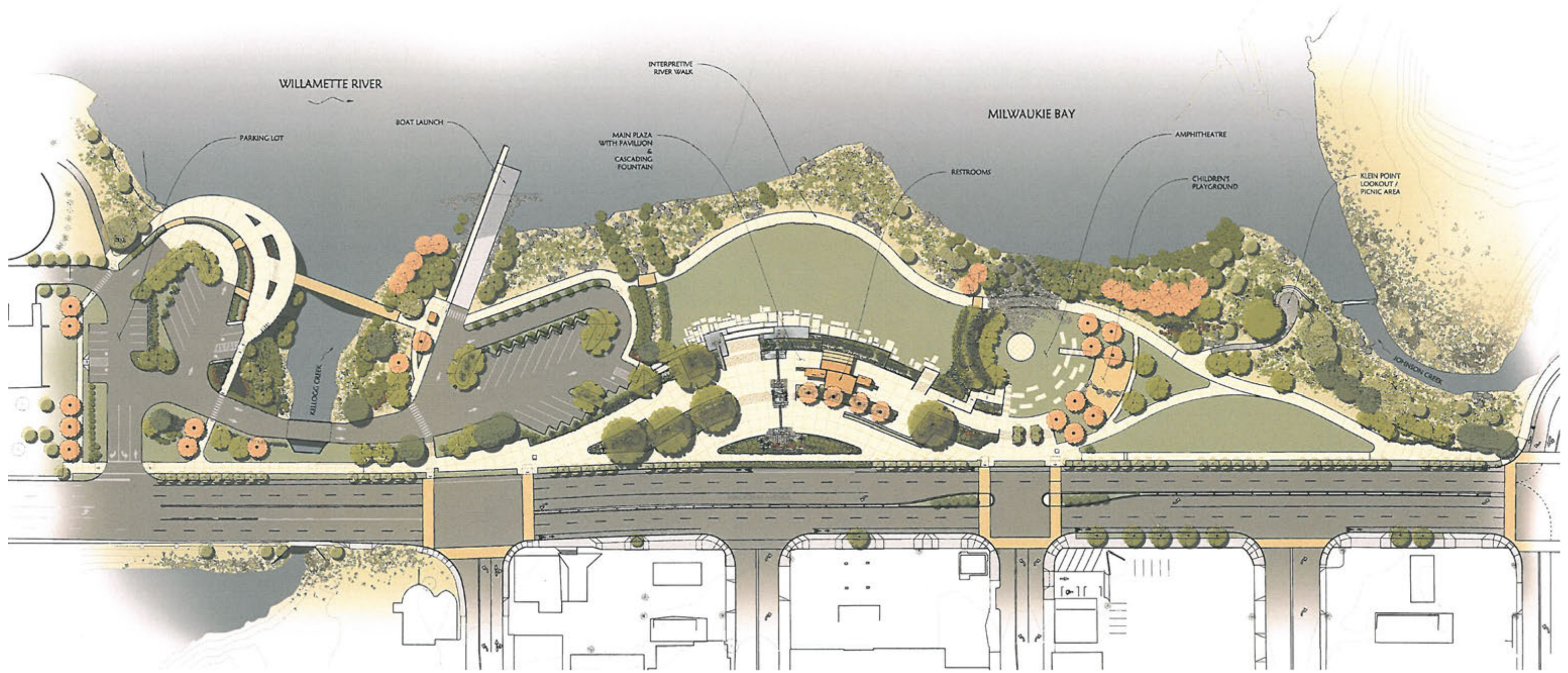

2010 MASTER PLAN

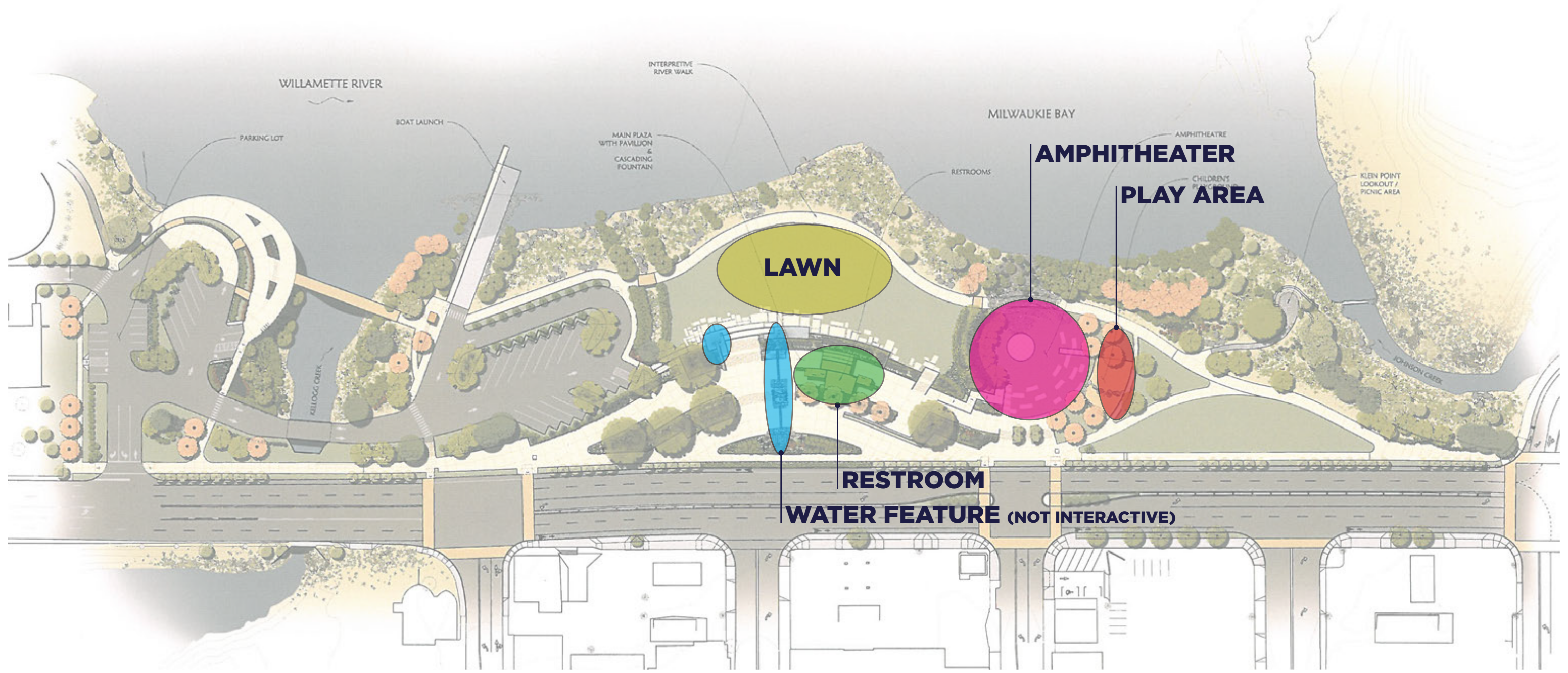

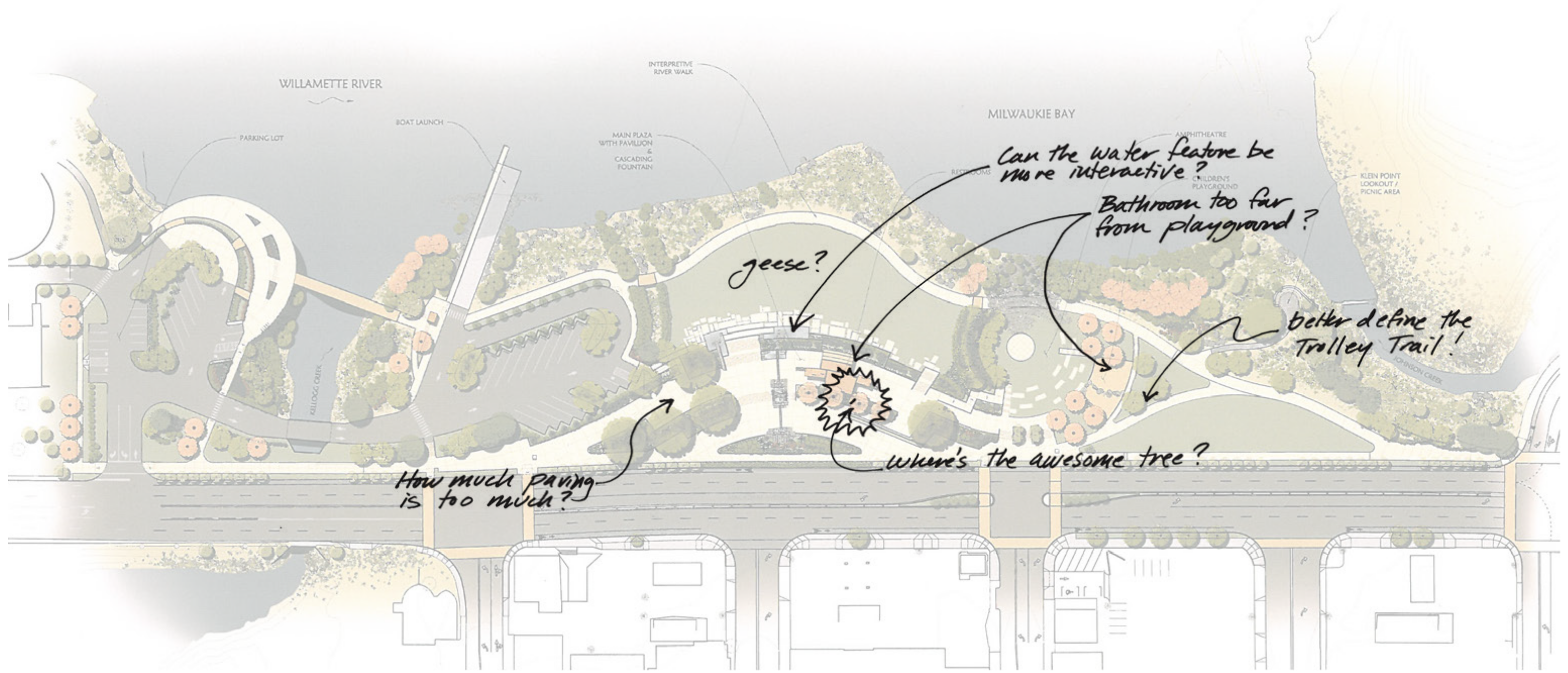

FLOW | Alternative 1



A free-flowing park design that takes its shape from the gradual waving forms of the river's movement, creating meandering pathways and spaces that indirectly take visitors from the upper bank to the river's edge.

Main Features

Pathways - Meandering pathways, reflecting the flow of the river

Plaza - Long, follows Hwy 99E, culminates in main plaza at Monroe Street

Water Feature - Interactive, paired with plaza, at street level, visible from downtown along Monroe Street

Play Area - Meandering space, features an upper, middle, and low area, nestled into bank below water feature

Amphitheater - Large size, flexible open lawn space can host a variety of events

Restroom - Adjacent to water feature, visible from Hwy 99E

Natural Area - Immersive space, upland habitat, provides pathways and seating, sits at north end of the site

Art/Interpretive Elements - Exists along the historic flood elevation lines, expressed from the south end to the north end of the site

Picnic Space - Sits above and overlooks amphitheater, connects to upper plaza, large covered space

Unique Features - Features (1) overlook at the river's edge

FLUVIAL | Alternative 2



A terraced park design that takes its forms from wave and sedimentation patterns associated with river environment. Spaces are interconnected through a series of pathways that indirectly take visitors from the upper bank to the river's edge.

Main Features

Pathways - Interconnected pathways, organized by park terraces

Plaza - Small, paired with overlook, sits above water feature

Water Feature - Interactive, nestled into bank, away from Hwy 99E, at same elevation as playground

Play Area - Compact space, features an upper and low area, water feature is at same elevation as the low area

Amphitheater - Large size, terraced lawn space, features a covered stage

Restroom - Sits above water feature, visible from Hwy 99E, integrated with terraced seating

Natural Area - Through space, sits adjacent to existing redwood tree

Art/Interpretive Elements - Exists as a series of nodes, expressed at select locations throughout the site

Picnic Space - Sits between water feature and amphitheater, small open space

Unique Features - Features a small raised seating area overlooking amphitheater

VISTA | Alternative 3



A linear park design with angular spaces that aligns visitors with views across the river and creates straight pathways that directly take visitors from the upper bank to the river's edge.

Main Features

Pathways - Linear pathways, directly link upper bank to river

Plaza - Small, sits above amphitheater, seating steps provide views to river

Water Feature - Interactive, connects to historic trolley alignment, visible from downtown along Jefferson Street

Play Area - Compact space, features an upper and low area, water feature is at same elevation as the upper area, closer to parking lot, bridge spans over low area

Amphitheater - Medium size, terraced lawn space, features a non-covered stage

Restroom - Adjacent to water feature and play area, visible from Hwy 99E

Natural Area - Immersive space, lowland habitat, provides elevated walkway and seating, sits adjacent to river bank

Art/Interpretive Elements - Exists along the historic alignment of the trolley tracks, integrates with the water feature

Picnic Space - Sits raised above planting in forested space, connects to upper plaza, overlooks amphitheater

Unique Features - Features (2) overlooks at the river's edge

ALTERNATIVE COMPARISON

FLOW | Alternative 1



FLUVIAL | Alternative 2

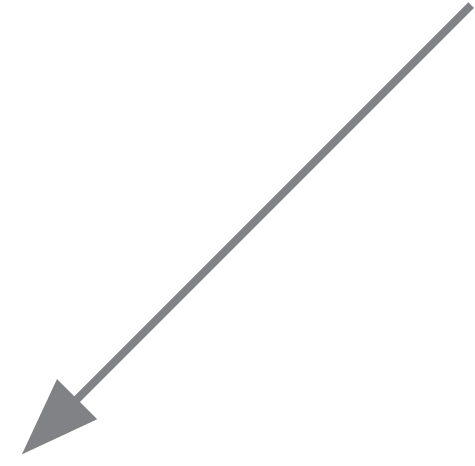
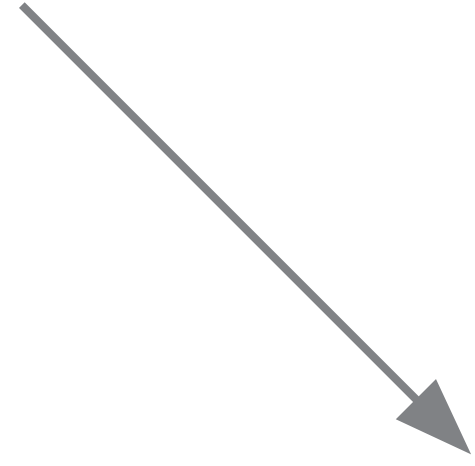

FINAL DESIGN

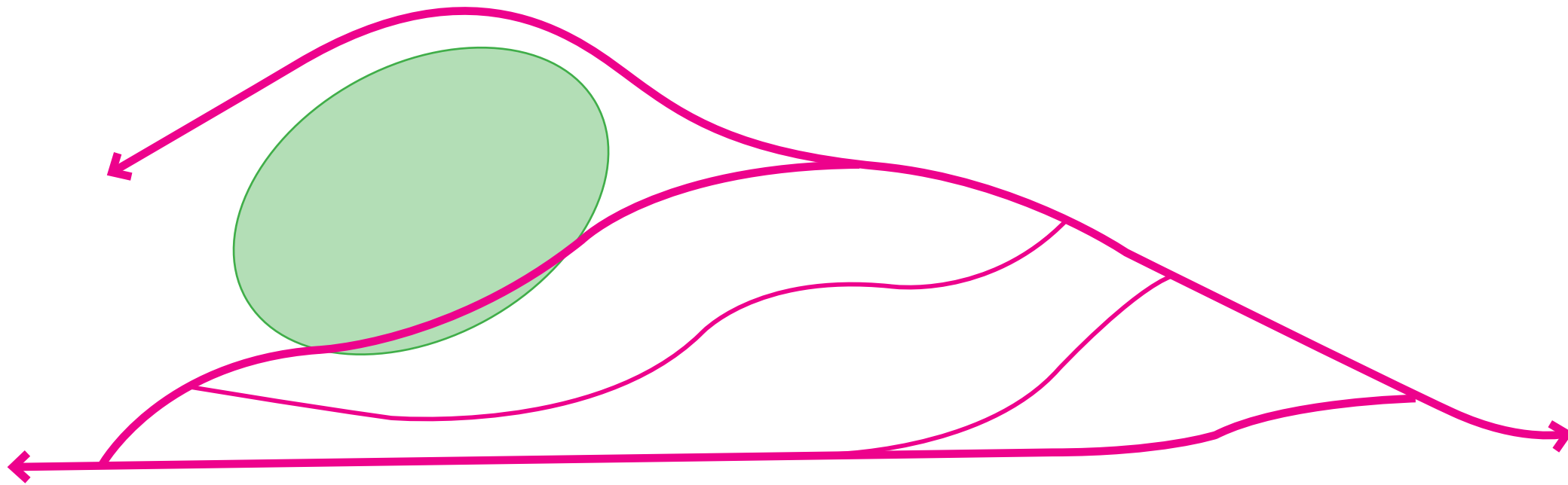



willamette river

99E

se washington

se jefferson

se monroe

se jackson

se harrison

FINAL DESIGN

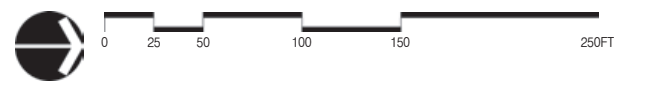



willamette river

PLAY AREA

**LAWN/
AMPHITHEATER**

RESTROOM

99E

WATER FEATURE

se washington

se jefferson

se monroe

se jackson

se harrison

FINAL DESIGN



2010 MASTER PLAN

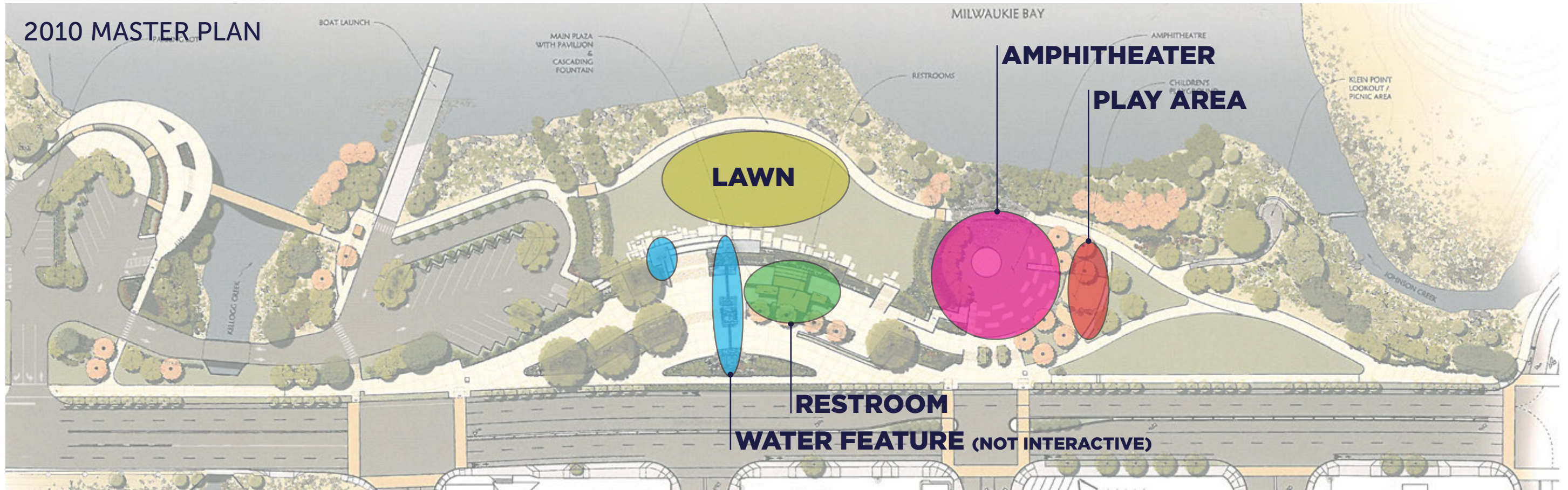

PROGRAM COMPARISON



LEGEND

- | | | | | | |
|---|-----------------------------------|----|----------------------------------|----|----------------------------------|
| 1 | Lawn/Amphitheater | 10 | River View Seating | 19 | Drop-off / Loading Area |
| 2 | Playground | 11 | Light Watercraft Staging Area | 20 | Existing Parking Lot |
| 3 | Interactive Water Feature | 12 | Picnic Area | 21 | Existing Boat Ramp |
| 4 | Restroom Building | 13 | Natural Area (Lowland Habitat) | 22 | Existing Light Watercraft Launch |
| 5 | Trolley Trail | 14 | Stormwater Facility | 23 | Existing Klein Point |
| 6 | Monroe St. Entry Plaza | 15 | Planting Area | 24 | Existing Restroom |
| 7 | Picnic Overlook w/Shade Structure | 16 | Event Stage | 25 | Existing ADA Parking Space |
| 8 | Nature Walk (Upland Habitat) | 17 | Winter Solstice Fire Pit w/Cover | 26 | Existing Large Redwood Tree |
| 9 | Pedestrian Bridge over Bioswale | 18 | River Overlook w/Seating | | |

FINAL DESIGN

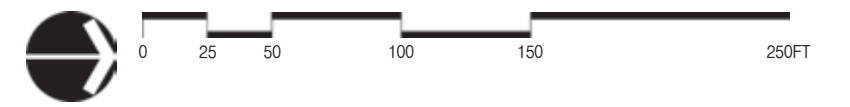

LEGEND

- ADA Accessible Path
- Non-ADA Path
- ↔ Trolley Trail
- ↔ Crosswalk



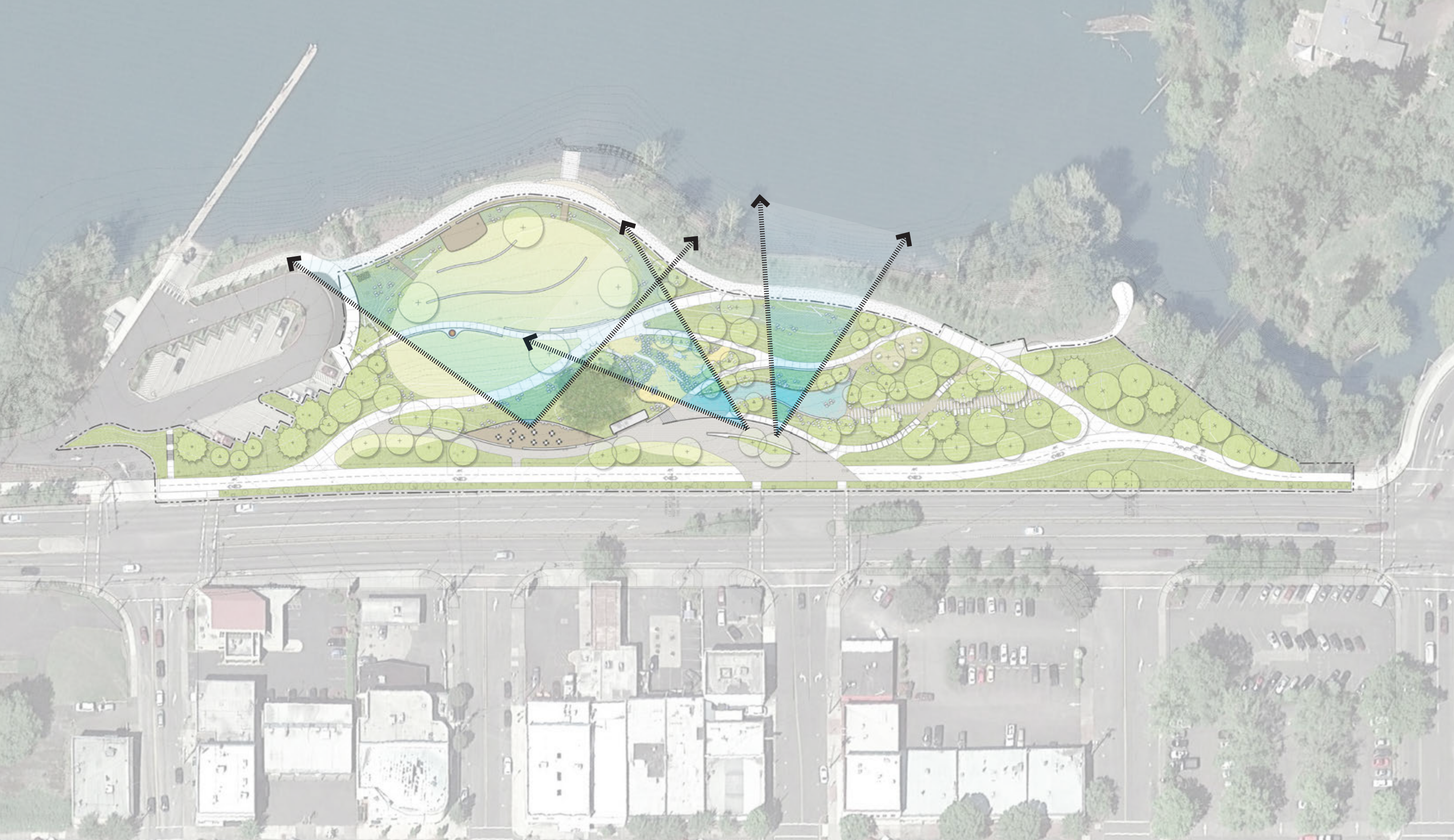

FINAL DESIGN | Primary Views



FINAL DESIGN | Potential Event Layout (Tents)



(2) food carts

(4-5) food carts



Movie Screen

(17) kayaks

NCPRD Rec Mobile



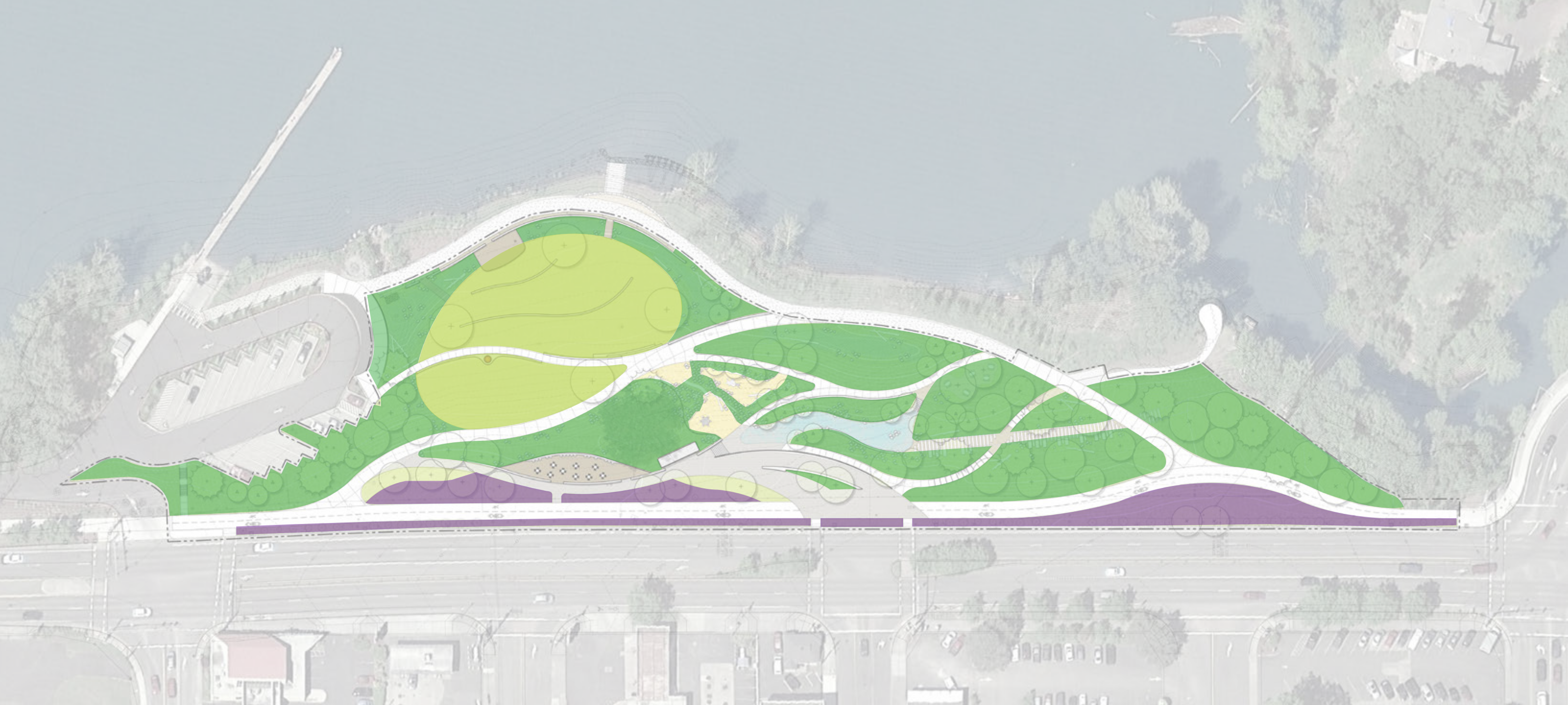

turf planting



naturalistic planting



ornamental planting



FINAL DESIGN | Planting Typologies

PERSPECTIVE RENDERINGS



AERIAL VIEW



KLEIN POINT

NATURE WALK

INTERACTIVE WATER
FEATURE

MONROE STREET
ENTRY PLAZA

PLAY AREA

RESTROOM

PICNIC TERRACE

INFORMAL LAWN

TROLLEY TRAIL

PICNIC AREA

EXISTING LIGHT
WATERCRAFT LAUNCH

AMPHITHEATER LAWN

AMPHITHEATER STAGE

EXISTING RIVER PATH

DROP-OFF /
LOADING AREA

AERIAL VIEW



AMPHITHEATER



AMPHITHEATER

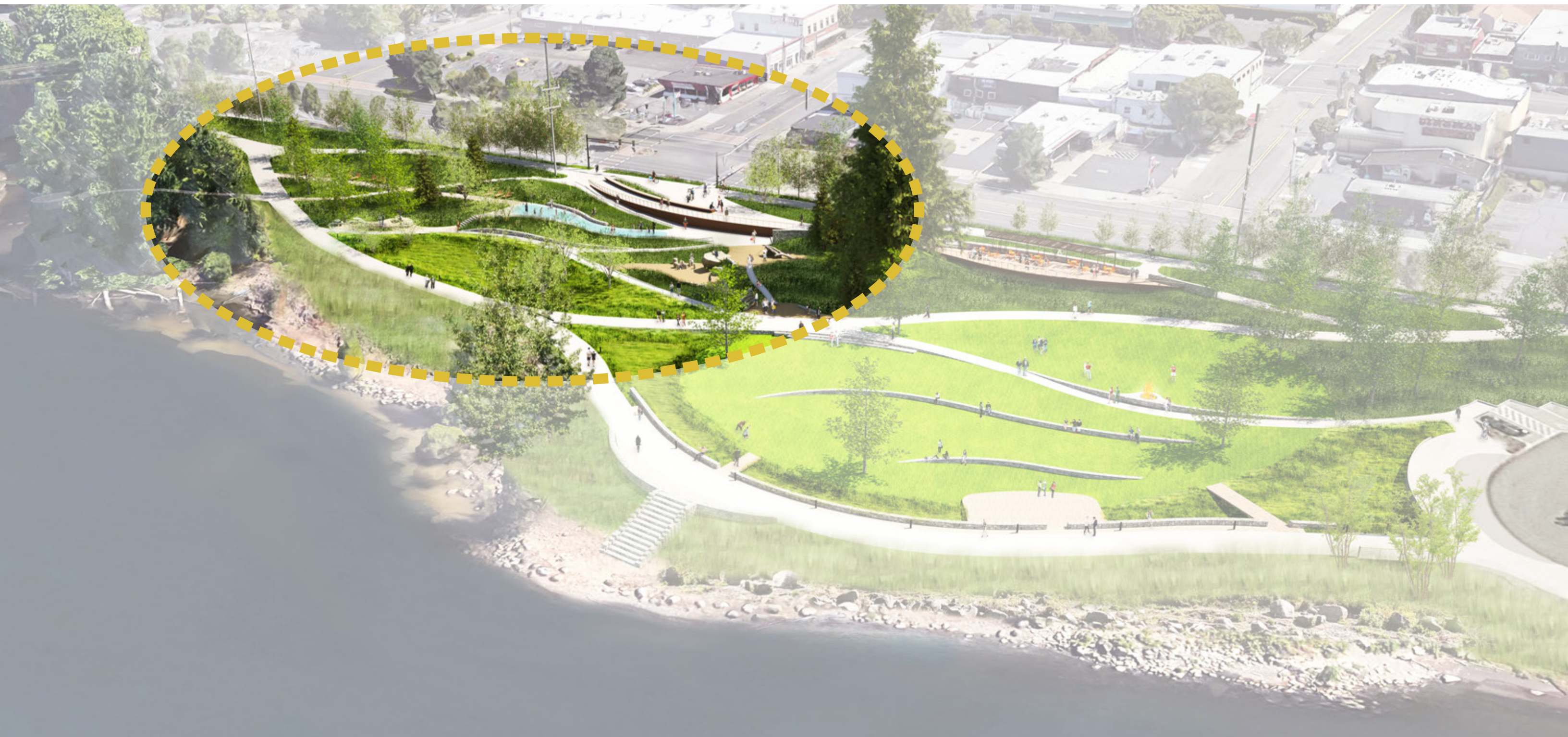

PLAZA/WATER FEATURE/PLAY AREA



PLAZA/WATER FEATURE/PLAY AREA



PLAZA/WATER FEATURE/PLAY AREA
CROSS SECTION THROUGH SLOPE

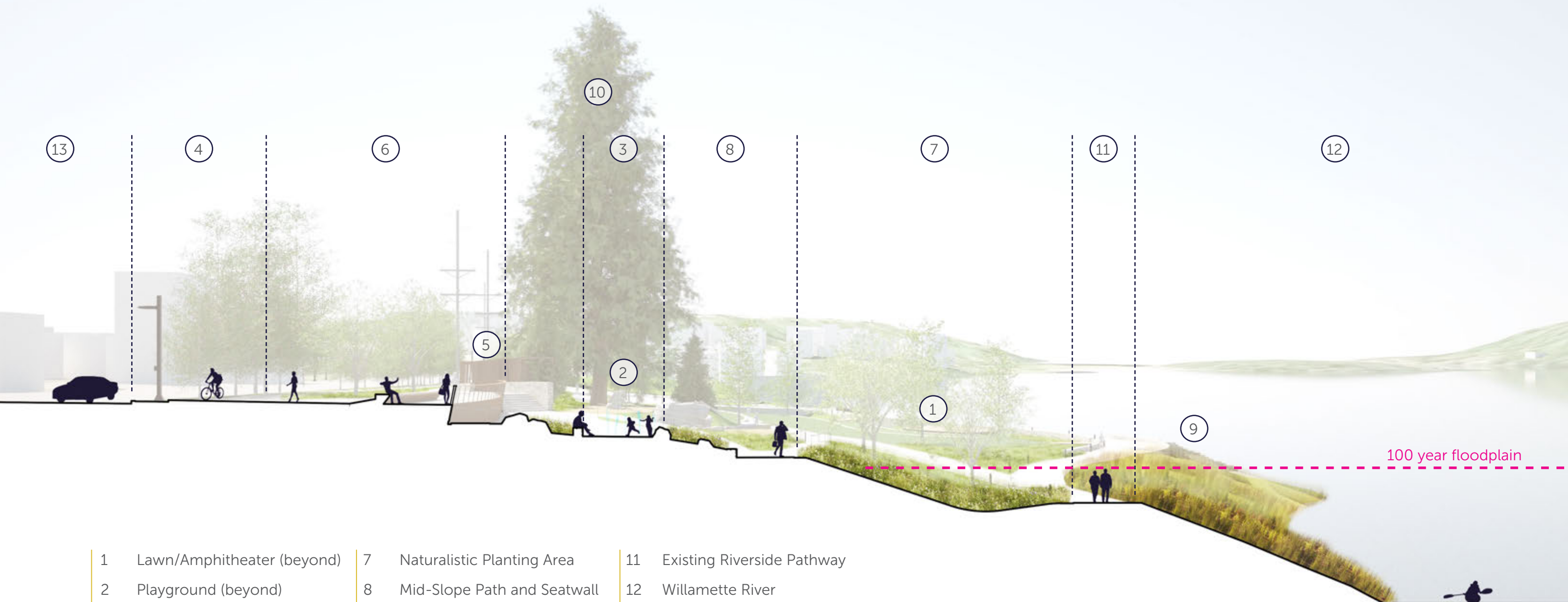

LEGEND

- | | | | | | |
|---|----------------------------|----|--|----|----------------------------|
| 1 | Lawn/Amphitheater (beyond) | 7 | Naturalistic Planting Area | 11 | Existing Riverside Pathway |
| 2 | Playground (beyond) | 8 | Mid-Slope Path and Seatwall | 12 | Willamette River |
| 3 | Interactive Water Feature | 9 | Light Watercraft Staging Area (beyond) | 13 | 99E/McLoughlin Blvd |
| 4 | Trolley Trail | | | | |
| 5 | Restroom (beyond) | 10 | Existing Large Redwood Tree (beyond) | | |
| 6 | Monroe St. Entry Plaza | | | | |

PLAZA/WATER FEATURE/PLAY AREA | Section



PREFERRED ALTERNATIVE | Ramp to Play Area and Water Feature



PREFERRED ALTERNATIVE | Ramp to Play Area and Water Feature



willamette river

99E

se washington

se jefferson

se monroe

se jackson



PREFERRED ALTERNATIVE | Picnic Terrace

Timeline for Project Completion

Design & Review

July 2018 - April 2019

Funding Plan

Ongoing - January 2020+

Construction Docs

June 2019 - January 2020

Permits/Approvals

August 2019 - January 2020

Bidding

3 months; TBD per funding plan

Construction

12 months; TBD per funding plan

Open House & Conversation

The Final Design

General questions and comments

Integrating Art, History & Culture

What about your community and this area is important to express -- past, present & future?

Getting Here & Getting Around

How will you get to the park? And what opportunities and challenges exist?

Bringing the Park to Life

What events, programs & activities most interest you and keep the park alive with activity?

Funding a Big Park Project

How do you fund a significant park project when it is a local and regional amenity?

KLEIN POINT

RAIL LINE NATURE WALK

INTERACTIVE WATER
FEATURE

MONROE STREET
ENTRY PLAZA

PLAY AREA

RESTROOM

PICNIC TERRACE

INFORMAL LAWN

TROLLEY TRAIL



PICNIC AREA

EXISTING LIGHT
WATERCRAFT LAUNCH

AMPHITHEATER LAWN

AMPHITHEATER STAGE

EXISTING RIVER PATH

DROP-OFF /
LOADING AREA

AERIAL VIEW



LEGEND

- | | | | | | |
|---|-----------------------------------|----|----------------------------------|----|----------------------------------|
| 1 | Lawn/Amphitheater | 10 | River View Seating | 19 | Drop-off / Loading Area |
| 2 | Playground | 11 | Light Watercraft Staging Area | 20 | Existing Parking Lot |
| 3 | Interactive Water Feature | 12 | Picnic Area | 21 | Existing Boat Ramp |
| 4 | Restroom Building | 13 | Natural Area (Lowland Habitat) | 22 | Existing Light Watercraft Launch |
| 5 | Trolley Trail | 14 | Stormwater Facility | 23 | Existing Klein Point |
| 6 | Monroe St. Entry Plaza | 15 | Planting Area | 24 | Existing Restroom |
| 7 | Picnic Overlook w/Shade Structure | 16 | Event Stage | 25 | Existing ADA Parking Space |
| 8 | Nature Walk (Upland Habitat) | 17 | Winter Solstice Fire Pit w/Cover | 26 | Existing Large Redwood Tree |
| 9 | Pedestrian Bridge over Bioswale | 18 | River Overlook w/Seating | | |

FINAL DESIGN

